

PLAN.

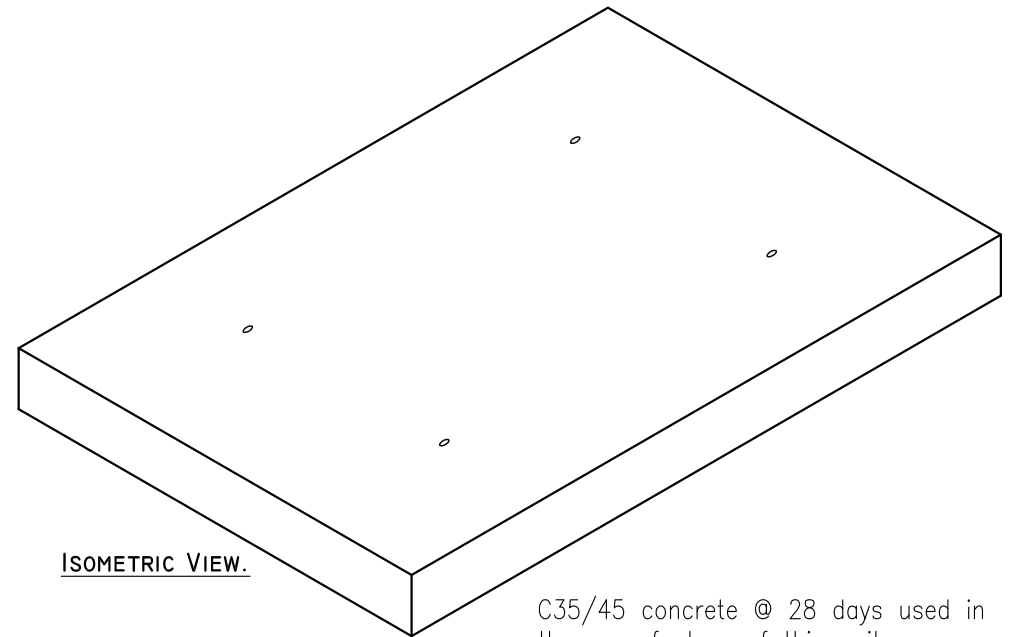

ISOMETRIC VIEW.

C35/45 concrete @ 28 days used in the manufacture of this unit.

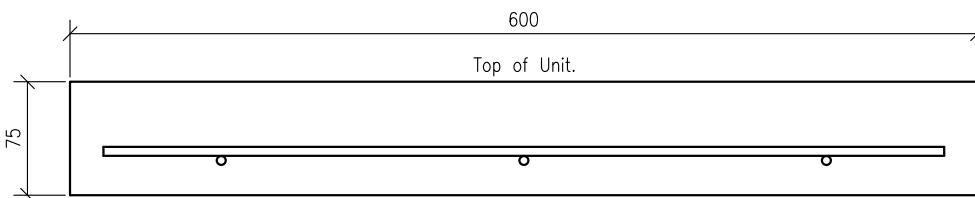

SECTION.

Steel reinforcing to consist of A142 mesh reinforcement – bottom. Cover to bottom reinforcement = 20mm. Cover to sides = 15mm. Rebar located by patent spacers. Reinforcement grade = 500N/mm². Finish – F2 (timber float) with square edges all round. 4No. M12mm lifting sockets cast in to top for installation purposes.

Weight of Unit = 98kg.

- DO NOT SCALE USE FIGURED DIMENSIONS ONLY.
- ALL DIMENSIONS TO BE CHECKED ON SITE.
- A.P.C TO BE INFORMED OF ANY DISCREPANCIES BEFORE WORK PROCEEDS.

© COPYRIGHT: Ardee Precast Concrete.
This drawing or any part thereof may not be copied or otherwise reproduced without the written permission of Ardee Precast Concrete.

Project:

TECHNICAL DATA SHEET.

Sheet Size:

A4

Title:

**DUCT COVER - TYPE 3.
900 x 600 x 75MM THICK.**

Drawing Scale:

1:5, 1:10,

Drawn By:

N.D.

Drawing No:

APC - 907

Revision:

A

Date:

21-09-2015

Checked By:



Ardee Precast Concrete Ltd.

Townparks, Ardee, Co. Louth.

Tel. +353(0)41 6856372

Email. info@ardeeprecastconcrete.ie

www.ardeeprecastconcrete.ie

Also:

Plot B, Old Darby Business Park, Station Road,
Old Darby, Melton Mowbray, LE14 3NJ

Tel. 01949 838647 Email. info@apccivils.co.uk