

PLAN.

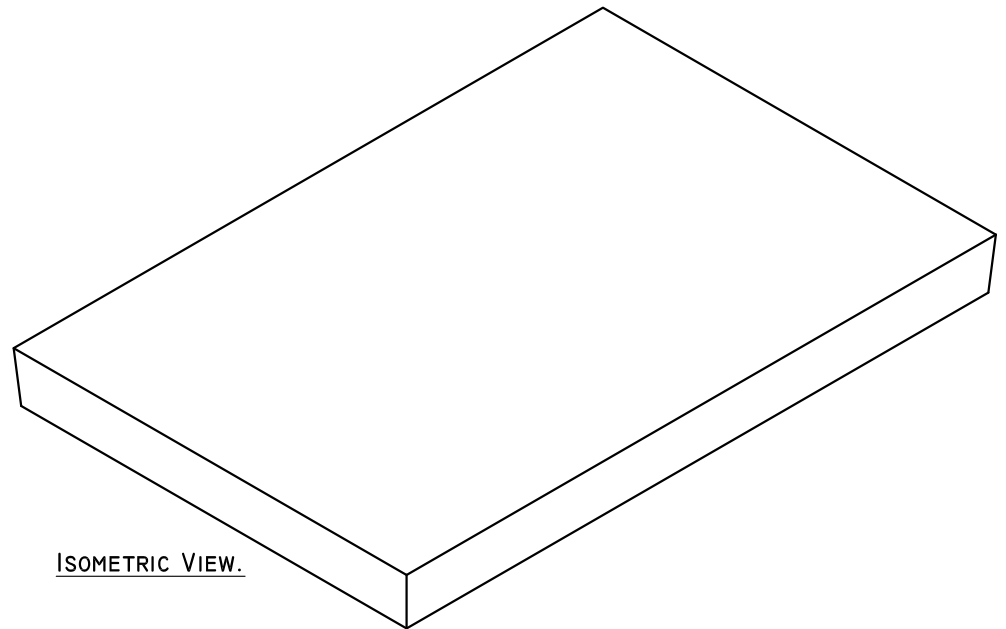

ISOMETRIC VIEW.

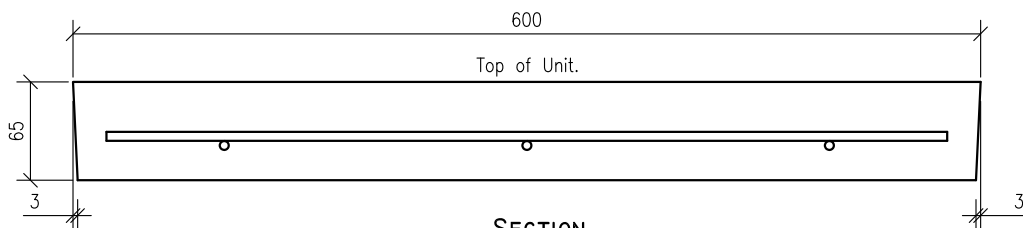

SECTION.

Loading Capacity :-

700mm clear span (100mm bearing both sides) = 4.50kN Point Load or 5kN/m² UDL.

Weight of Unit = 85kg.

C35/45 concrete @ 28 days used in the manufacture of this unit.

Steel reinforcing to consist of A142 mesh reinforcement – bottom. Cover to bottom reinforcement = 20mm. Cover to sides = 15mm. Rebar located by patent spacers. Reinforcement grade = 500N/mm².

E Title Block Amended. May 2020

- DO NOT SCALE USE FIGURED DIMENSIONS ONLY.
- ALL DIMENSIONS TO BE CHECKED ON SITE.
- A.P.C TO BE INFORMED OF ANY DISCREPANCIES BEFORE WORK PROCEEDS.

© COPYRIGHT: Ardee Precast Concrete.
This drawing or any part thereof may not be copied or otherwise reproduced without the written permission of Ardee Precast Concrete.

Project:

TECHNICAL DATA SHEET.

Sheet Size:

A4

Title:

**DUCT COVER - TYPE I.
900 x 600 x 65MM THICK.**

Drawing Scale:

1:5, 1:10,

Drawn By:

N.D.

Drawing No:

APC - 902

Revision:

E

Date:

07-10-2011

Checked By:



Ardee Precast Concrete Ltd.

Townparks
Ardee
Co. Louth

Tel. +353(0)41 6856372
Fax. +353(0)41 6857216

Email us at info@ardeeprecastconcrete.ie
Visit us at www.ardeeprecastconcrete.ie